

A.C. COMPRESSOR MOUNT 135R

Small Block Chevy - Long Water Pump
1987 and Later Cast Iron Head
Including Vortec - Passenger Side

The compressor belt will run in the outer grooves of the crank and water pump pulleys originally used for the factory alternator. It was designed to be used with our Driver's Side Alternator Mount.



We use a belt length of 60 - 61" with this mount on installations in our shop. However; this can vary with the diameter of your pulleys.

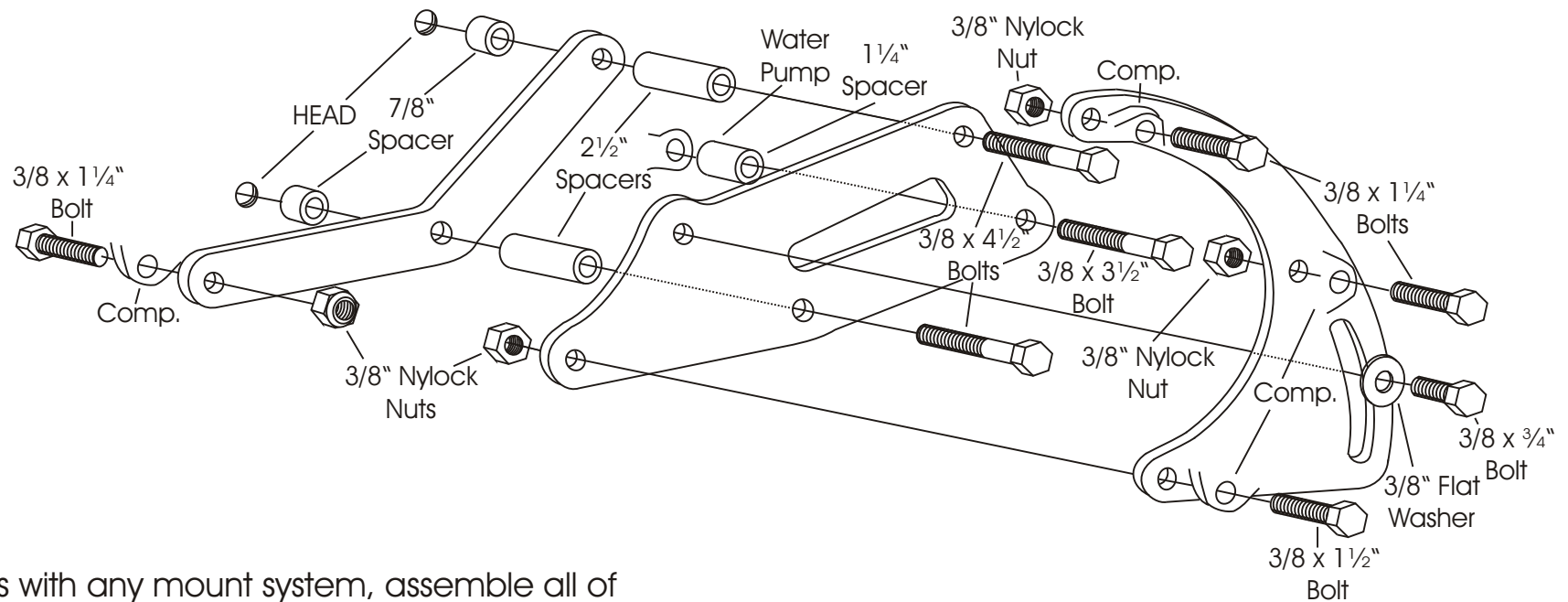

As with any mount system, assemble all of the brackets to engine BEFORE TIGHTENING THE BOLTS.

As with any part of this nature, make sure it fits your application before painting or plating. Parts that have been painted, plated, or modified may not be returned.

A.C.
COMPRESSOR
MOUNT
135R

Small Block Chevy - Long Water Pump
1987 and Later Cast Iron Head
Including Vortec - Passenger Side

ALAN GROVE COMPONENTS, INC.
27070 METCALF ROAD
LOUISBURG, KS 66053